

OKLAHOMA DEPARTMENT OF TRANSPORTATION				
FED. ROAD DIST. NO.	STATE	JOB PIECE NO.	FISCAL YEAR	TOTAL SHEETS
6	OKLA.			
DESCRIPTION		REVISIONS	DATE	

# SURVEY DATA SHEETS

## BRYAN COUNTY S.H. 78 SWO 4811(D)

STATE JOB NO. 27912(04)

INDEX OF SURVEY SHEETS

1. TITLE SHEET

STATE OF OKLAHOMA  
DEPARTMENT OF TRANSPORTATION  
SURVEY DIVISION

SWO 4811(D) J/P 27912(04) ;          CO. Bryan

**HORIZONTAL CONTROL:**  
 Oklahoma Coordinate System of 1927          Zone.  
 Oklahoma Coordinate System of 1983 South Zone.  
 Oklahoma Dept. of Transportation Plane Coordinate System of 1927          Zone.  
 Oklahoma Dept. of Transportation Plane Coordinate System of 1983          Zone.  
 Arbitrary Coordinate System

**HORIZONTAL PLANE DATUM DEFINITION:**  
 Oklahoma Department of Transportation coordinates were derived by multiplying the Oklahoma Coordinate Systems of 1927 or 1983 by the combined adjustment factor of 1.00010. The ODOT Coordinate System is 2350 feet above sea level.

1.          Primary Control          adjusted to          NGS & ODOT          (B) Order  
 Stations OKAR, TXSR, T212  
 A) Closure before adjustment X         ; Y          Angles           
 Trav. Length         ; No. Angles           
 B)         ; is          ( ) Order before adjustment.  
 C) Method of Distance Measurement:  
 Electronic  GPS  Triangulation  Tied  
 D) Instrument used for angles         

2.          Secondary Control          adjusted to          Primary Control          (B) Order  
 Stations B-7-648 B-7-649  
 A) Closure before adjustment X         ; Y 0.00 Angles           
 B)         ; is          Order, Tied to          NGS & ODOT  
 C) Method of Distance Measurement:  
 Electronic  GPS  Triangulation  Tied  
 D) Instrument used for angles         

VERTICAL CONTROL IS (3rd) order. Level Line taken from          BM # 3  
 (1st) order and tied to          SWO 4181 (1) (3rd) order.  NGVD 29 datum  
 NAVD 88 datum

**ACCURACY DEFINITION:**  
 (1) HORIZONTAL: (3rd Order = Class I = 1 : 10,000'  
 (3rd Order = Class II = 1 : 5,000'  
 (2) VERTICAL: (1st Order = 0.017 Ft. x sqrt. of Mi.) (2nd Order = 0.035 Ft. x sqrt. of Mi.)  
 (3rd Order = 0.050 Ft. x sqrt. of Mi.)

Distribution:  
 Copy w/survey reports          Brendan Blansett  
 Copy in each Alignment          Professional Land Surveyor  
 and level book         

(FORM SD #20)  
 Rev. 11/03          9-Feb-12  
         Date

### PROJECT LOCATION

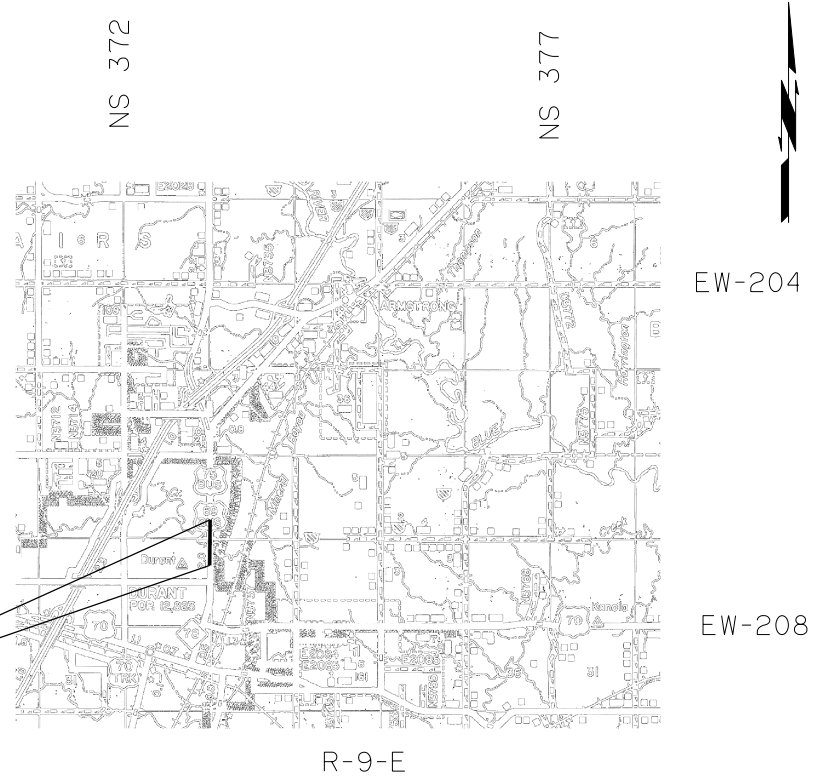

STATE OF OKLAHOMA  
DEPARTMENT OF TRANSPORTATION

SWO 4811(D) Job/Piece 27912(04) Engr. Contract No.         

### LAND SURVEYOR'S CERTIFICATION

I hereby certify that all land and property sub-division distances, angles, corners, and monumentation made or used in conjunction with this survey and depicted or recorded herein or hereon were recovered, established or re-established in substantial conformity with:

- Applicable instructions contained in the U.S. Government Bureau of Land Management publication "Manual of Survey Instruction";
- Its supplement, "Restoration of Lost or Obliterated Corners and Sub-division of Sections";
- "Oklahoma Minimum Standards for the Practice of Land Surveying" as adopted by the State Board of Licensure for Professional Engineers and Land Surveyors; and
- Sound land surveying practices;

including a thorough search, study, analysis and consideration of all existing records and field evidence.

I further certify that all survey monuments depicted exist and that all land survey work was done by me or under my direct supervision.

Dated this 9<sup>th</sup> day of February, 2012.

Land Surveyor Brendan Blansett  
 Signature Brendan Blansett  
 Signature

Brendan Blansett, P.L.S.

Oklahoma Licensed Land Surveyor No. 1561

Certificate of Authorization No.         

SCALES 1" = 100'  
 SURVEY DATA SHEETS  
1" = 500'  
 GEOMETRIC DATA SHEETS

### SURVEY EXTENTS

SURVEY BEGAN: December 1, 2011.  
 SURVEY COMPLETED: February 9, 2012.

BRENDAN BLANSETT, PROFESSIONAL LAND SURVEYOR  
 CLAY MACK, TRANSPORTATION SPEC. I  
 MICHAEL BOLING, TRANSPORTATION TECH III  
 JOSEPH SPRINGFIELD, TRANSPORTATION TECH I

EQUIPMENT:  
 LEICA TC1800 TOTAL STA. SHC NO. ET0530  
 LEICA DNA10 DIGITAL LEVEL SHC NO. EL0582  
 LEICA GPS 500 SHC NO. EE0132  
 LEICA GPS 1200 SN 455882

Electronic File Transfer Disclaimer:  
 These Files, Drawings and/or Notes are provided for information only. The Oklahoma Department of Transportation (ODOT) and the Owner cannot be held responsible for the content or accuracy of these Files, Drawings and/or Notes due to conversions, software translations, or any other manipulation of said Files, Drawings and/or Notes. ODOT expressly disclaims any responsibility arising from any use of these Files, Drawings and/or Notes. To the full extent permitted by applicable law, the recipient of these Files, Drawings and/or Notes hereby agrees to defend, indemnify, and hold harmless ODOT and the Owner from and against any and all claims, suits, actions, damages, loss, liability or costs of every nature or description (including reasonable attorney's fees) arising from, or in any way attributable to or connected with any of these Files, Drawings and/or Notes.

THIS SURVEY MEETS THE OKLAHOMA MINIMUM STANDARDS FOR THE PRACTICE OF LAND SURVEYING AS ADOPTED BY THE OKLAHOMA STATE BOARD OF REGISTRATION FOR PROFESSIONAL ENGINEERS AND LAND SURVEYORS, JUNE 11, 2001.

SPECIFICATIONS FOR SURVEYS FOR PRIMARY AND SECONDARY HIGHWAYS DATED SEPTEMBER 11, 2001 GOVERN.  
 SDS 1 OF 5

OKLAHOMA DEPARTMENT OF TRANSPORTATION SURVEY DIVISION			
PLS	BLB		
DRAWN	BLB		
CHECKED			
APPROVED			
CREW	ANTLERS	SWO <u>4811(D)</u> STATE JOB NO. <u>27912(04)</u> SHEET NO. <u>500L</u>	